

**SHALLCO SERIES 26**

**Part Number:** 2657D 125VDCAXC

**General:**

Meets requirements for 1 - 25 ampere switching of resistive loads to .75 power factor at voltages to 600 V AC and 250 VDC resistive loads

**Electrical:**

- \* Ratings: 25A/120 VAC
- 15A/600 VAC
- 20A/600 VAC (RESISTIVE)
- 3A/125 VDC
- 1A/250 VDC



- \* Current carrying capacity: 25 amperes
- \* Dielectric Withstanding Voltage: 2200 Vrms
- \* Contact Resistance: Initial, 10 milliohms max.
- \* Insulation Resistance: 100 Megohms min., initial

\*Lighted panel voltage 24 to 140 VDC

**Mechanical:**

- \* Sections: 5
- \* Positions: See contact table
- \* Type Action: Nonshorting
- Detent type: Sections 1, 2, 3 - Spring Return
- Detent type: Sections 4 & 5, Slip Detent
- \* Indexing: 45°
- \* Rotational Life: 65,000 operations

**Materials and Finishes:**

- \* Rotors and Stators: Thermoset Plastic, UL 94VO
- \* Rotor contacts: Phosphor bronze
- \* Stator contacts: Silver plated copper, screw type
- \* Terminal hardware: silver plated brass
- \* Exterior Metal: Steel with zinc chromate finish
- \* Knob: thermoset phenolic



308 COMPONENTS DRIVE  
SMITHFIELD, NC 27577 USA

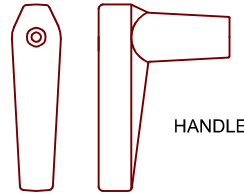

HANDLE

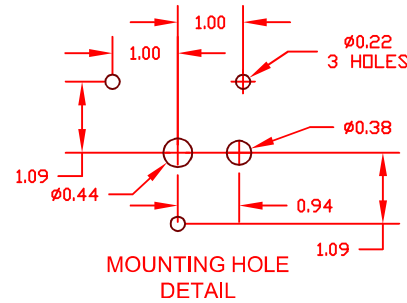

MOUNTING HOLE  
DETAIL

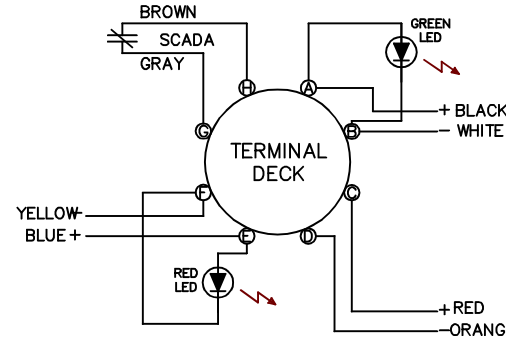

DECK	CONTACTS	POS.			
		TRIP	nat	nac	CLOSE
1	120-I-I-O13				X
	160-I-I-O17				X
2	210-I-I-O28	X			
	240-I-I-O25	X			
3	310-I-I-O32		X	X	
	350-I-I-O36		X	X	
4	420-I-I-O43			X	X
	460-I-I-O47			X	X
5	510-I-I-O52	X	X		
	550-I-I-O56	X	X		

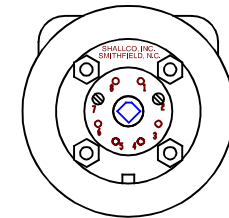
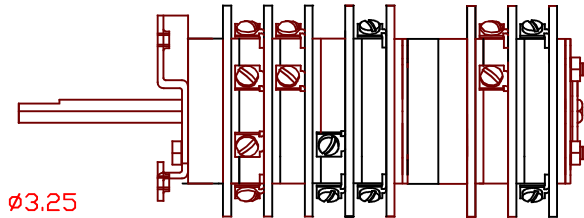
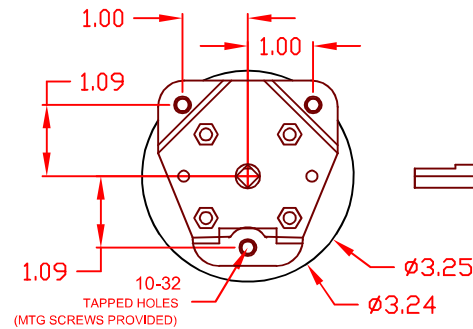
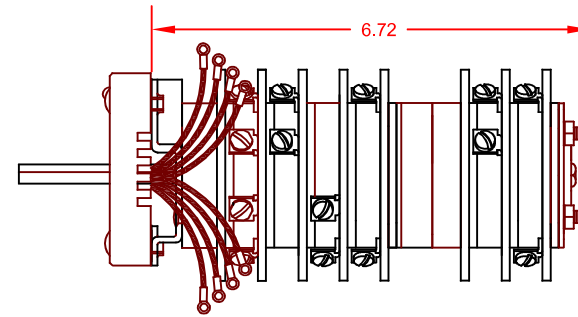
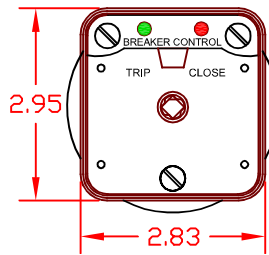

2657D 125VDCAXC



308 COMPONENTS DRIVE  
SMITHFIELD, NC 27577 USA