

SHALLCO SERIES 26
Part Number: 26202E



General:

Meets requirements for 1 - 25 ampere switching of resistive loads to .75 power factor at voltages to 600 V AC and 250 V DC resistive loads

Electrical:

- * Ratings: 25A/120 VAC
- 15A/600 VAC
- 20A/600 VAC (RESISTIVE)
- 3A/125 VDC
- 1A/250 VDC



- * Current carrying capacity: 25 amperes
- * Dielectric Withstanding Voltage: 2200 Vrms
- * Contact Resistance: Initial, 10 milliohms max.
- * Insulation Resistance: 100 Megohms min., initial

Mechanical:

- * Sections: 2
- * Positions: 8
- * Indexing: 45°
- * Rotational Life: 65,000 operations

Materials and Finishes:

- * Rotors and Stators: Thermoset Plastic, UL 94VO
- * Rotor contacts: Phosphor bronze
- * Stator contacts: Silver plated copper, screw type
- * Terminal hardware: silver plated brass
- * Exterior Metal: Steel with zinc chromate finish
- * Knob: thermoset phenolic

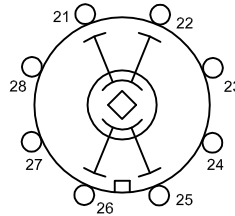
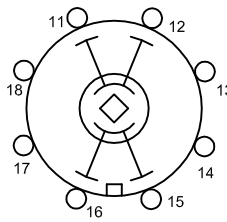

DECK	CONTACTS				POS			
	1	2	3	4	1	2	3	4
1	11	12	13	14	X			
	12	13	14	15		X		
	13	14	15	16			X	
	14	15	16	17				X
	15	16	17	18	X			
	16	17	18	11		X		
	17	18	11	12			X	
	18	11	12	13				X
2	21	22	23	24	X			
	22	23	24	25		X		
	23	24	25	26			X	
	24	25	26	27				X
	25	26	27	28	X			
	26	27	28	21		X		
	27	28	21	22			X	
	28	21	22	23				X

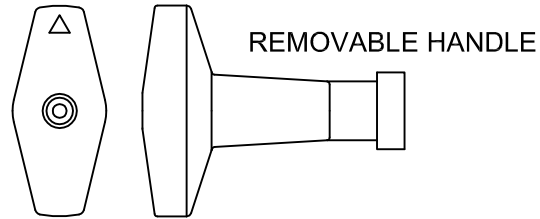

PANEL DRILLING

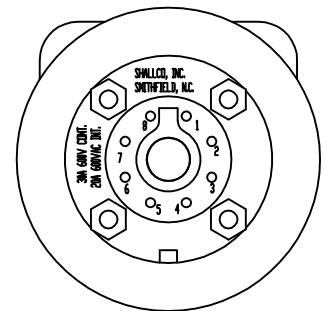
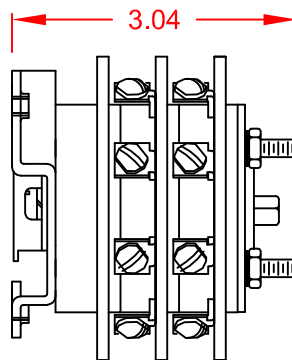
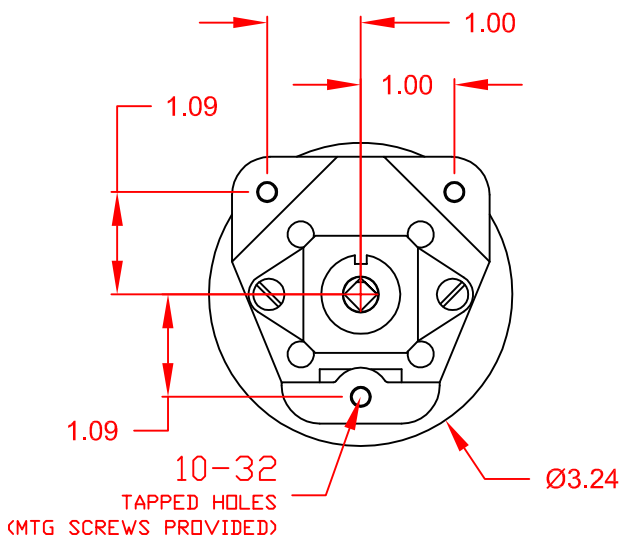
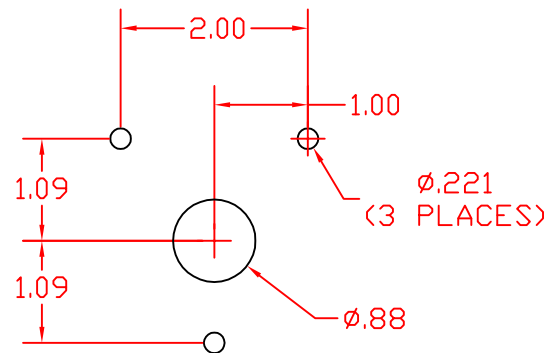

26202E



308 COMPONENTS DRIVE
 SMITHFIELD, NC 27577 USA