

SHALLCO SERIES 16 SWITCH



PART NO: 16C1-B-2
NO. OF SECTIONS: 2
INDEXING: 45°
CIRCUIT: C (SEE SCHEMATIC)
TYPE ACTION: NON-SHORTING
DETENT: STANDARD
STOPS INSTALLED: NO
TERMINALS: SCREW TYPE, HARDWARE SUPPLIED
PHENOLIC POINTER KNOB: SUPPLIED
MOUNTING HARDWARE: SUPPLIED

ELECTRICAL RATINGS:

13 A @ 125 VAC
5 A @ 250 VAC
3 A @ 600 VAC
5 A @ 30 VDC
1 A @ 125 VDC

DIELECTRIC WITHSTANDING VOLTAGE: 1500 VRMS
CONTACT RESISTANCE: 10 MILLIOHMS MAX. INITIAL
INSULATION RESISTANCE: 1000 MEGHOHMS, INITIAL

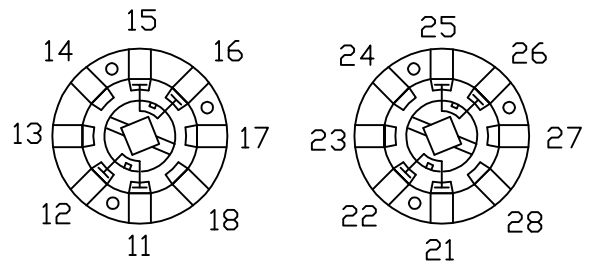

SCHEMATIC DIAGRAM

CIRCUIT "C"

WIPERS LOCATED ON TERMINALS 1 & 2
AND 5 & 6 WITH SHAFT AND MOVING
STOP AS SHOWN IN VIEWS BELOW

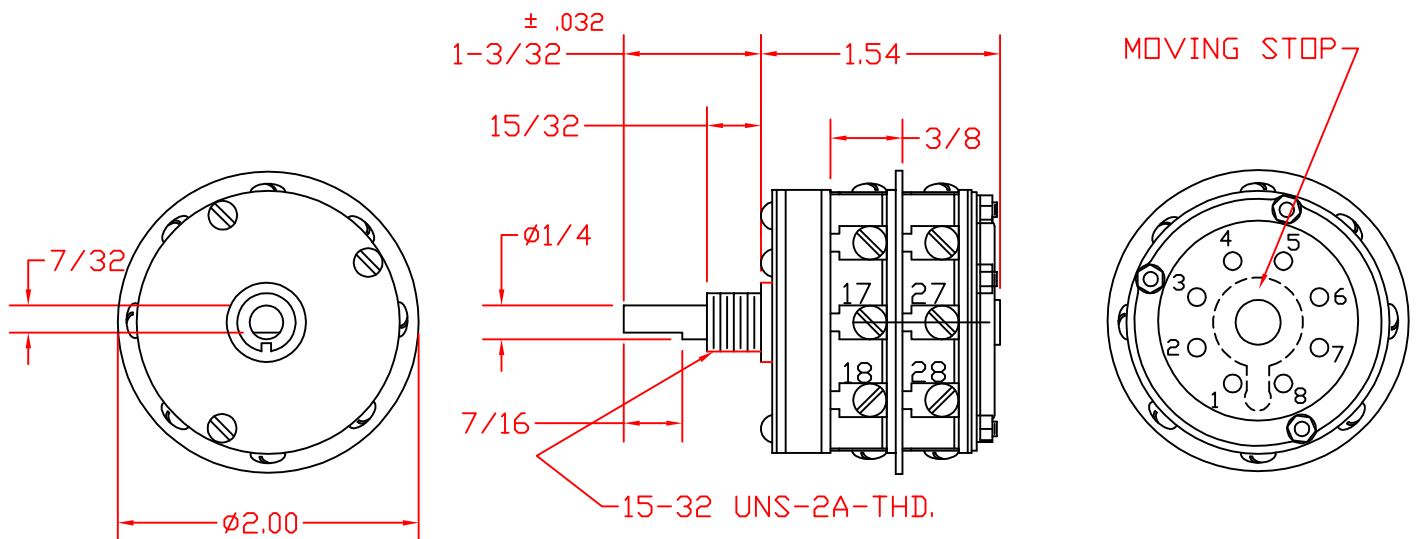

DESCRIPTION

16C1-B-2

REV B



308 COMPONENTS DRIVE
SMITHFIELD, NC 27577 USA