

SHALLCO SERIES 26

Part Number: 2608C

AMMETER TRANSFER SWITCH

3-phase, 2 Current Transformers



308 COMPONENTS DRIVE
SMITHFIELD, NC 27577 USA

General:

Meets requirements for 1 - 25 ampere switching of resistive loads to .75 power factor at voltages to 600 V AC and 250 V DC resistive loads

Electrical:

- * Voltages: 250 V DC, 600 V AC
- * Current carrying capacity: 25 amperes
- * Dielectric Withstanding Voltage: 2200 Vrms
- * Contact Resistance: Initial, 10 milliohms max.
- * Insulation Resistance: 100 Megohms min., initial



Mechanical:

- * Sections: 6
- * Positions: 5 See Schematic Diagram
- * Indexing: 45°
- * Rotational Life: 65,000 operations

Materials and Finishes:

- * Rotors and Stators: Thermoset Plastic, UL 94VO
- * Rotor contacts: Phosphor bronze
- * Stator contacts: Silver plated copper, screw type
- * Terminal hardware: silver plated brass
- * Exterior Metal: Steel with zinc chromate finish
- * Knob: thermoset phenolic

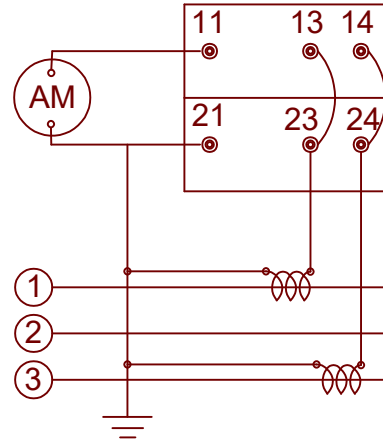

TRUTH TABLE/ STATOR DIAGRAMS SHOWN IN THE "OFF" (NO. 1 POSITION)

DECK	CONTACTS	POSITIONS			
		OFF *	1	2	3
1	11-O-13	X	X	X	X
	11-O-14			X	X
2	21-O-23	X	X		X
	21-O-24	X	X	X	

* denotes make-before-break

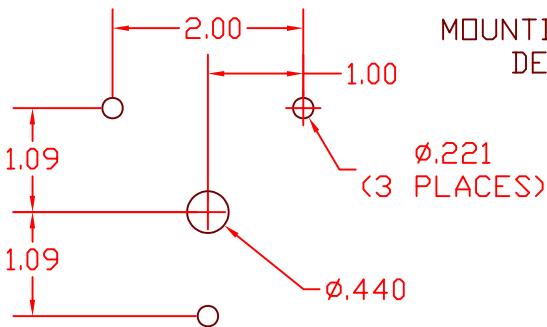
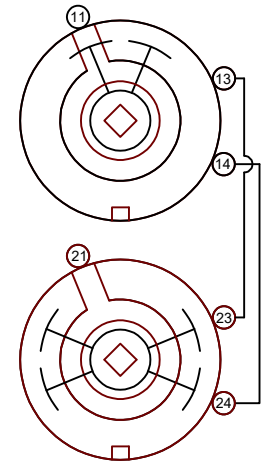

MOUNTING HOLE
DETAIL

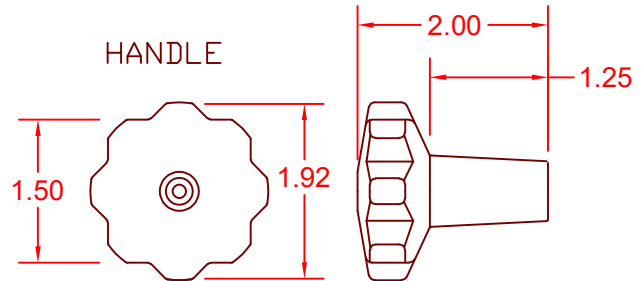

HANDLE

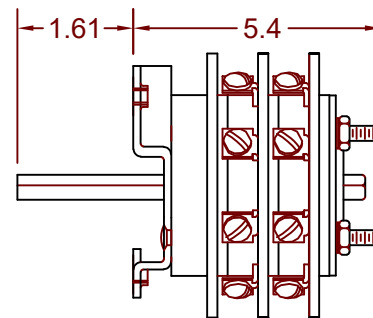
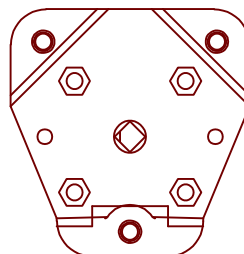
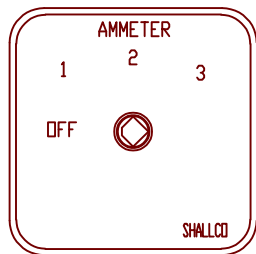

2608C



308 COMPONENTS DRIVE
SMITHFIELD, NC 27577 USA

HANDLE TYPE: ROUND, KNURLED

"A" DIM: 1.6

"B" DIM: 2.78

"C" DIM: 1/2