

**SHALLCO SERIES 26**  
**Part Number: 26503B-2**



**General:**

Meets requirements for 1 - 25 ampere switching of resistive loads to .75 power factor at voltages to 600 V AC and 250 V DC resistive loads

**Electrical:**

\* Ratings:



- 25A/120 VAC
- 15A/600 VAC
- 20A/600 VAC (RESISTIVE)
- 3A/125 VDC
- 1A/250 VDC

- \* Current carrying capacity: 30 amperes
- \* Dielectric Withstanding Voltage: 2200 Vrms
- \* Contact Resistance: Initial, 10 milliohms max.
- \* Insulation Resistance: 100 Megohms min., initial

**Mechanical:**

- \* Sections: 3
- \* Positions: 2 (stops set in # 1 & #7)
- \* Circuit: See Contact Table and Stator Diagram
- \* Nonshorting Operation
- \* Indexing: 45° positive detent
- \* Rotational Life: 65,000 operations

**Materials and Finishes:**

- \* Rotors and Stators: Thermoset Plastic, UL 94VO
- \* Rotor contacts: Phosphor bronze
- \* Stator contacts: Silver plated copper, screw type
- \* Terminal hardware: silver plated brass
- \* Exterior Metal: Steel with zinc chromate finish
- \* Knob: thermoset phenolic

CONTACT TABLE

DECK	CONTACTS	POS.	
		1	2
1	11-0-1-1-013	X	
	12-0-1-1-014		X
	15-0-1-1-017	X	
	16-0-1-1-018		X
2	21-0-1-1-023	X	
	22-0-1-1-024		X
	25-0-1-1-027	X	
	26-0-1-1-028		X
3	31-0-1-1-033	X	
	32-0-1-1-034		X
	35-0-1-1-037	X	
	36-0-1-1-038		X

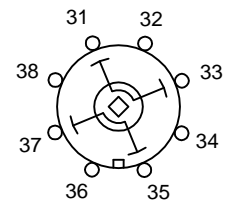
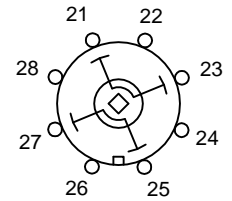
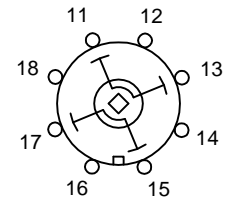

STATOR DIAGRAM

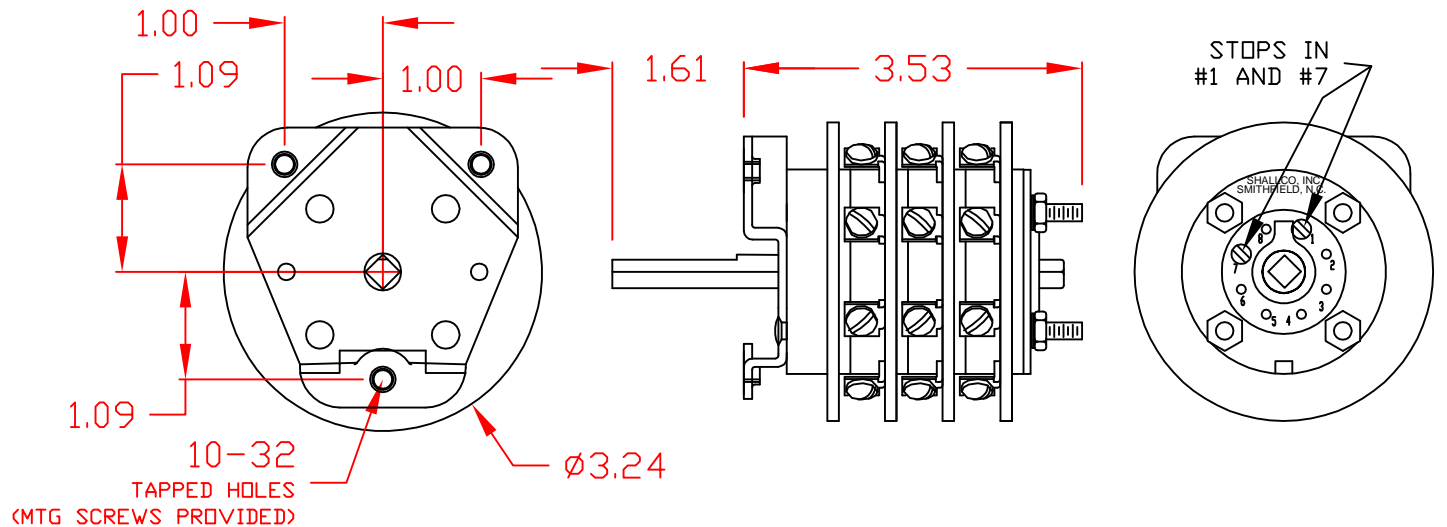
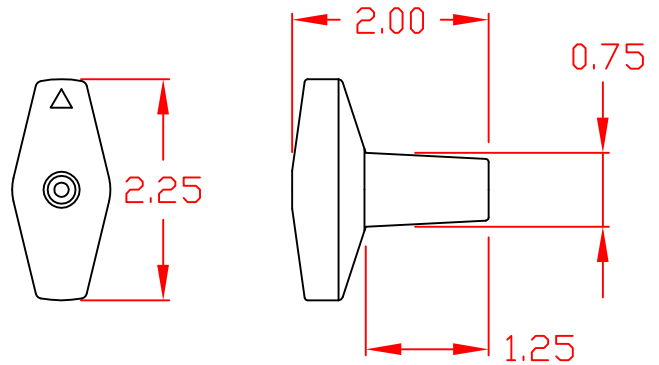

26503B-2

REV. A



308 COMPONENTS DRIVE  
 SMITHFIELD, NC 27577 USA

TERMINAL SCREW TIGHTENING TORQUE: : 8 IN-LBS.